



Indiana Conveyors Pvt. Ltd.

Indiana House, Marol Naka,
Andheri (E), Mumbai - 400 059.
Tel.: +91(22) 2850 4743, 2850 5611
Fax: +91(22) 2850 5154
E-mail: marketing@indianagroup.com
www.indianagroup.com

Indiana

Bulk Material Handling Projects

Branch Offices

- **Delhi**
- **Kolkata**
- **Chennai**
- **Hyderabad**
- **Baroda**

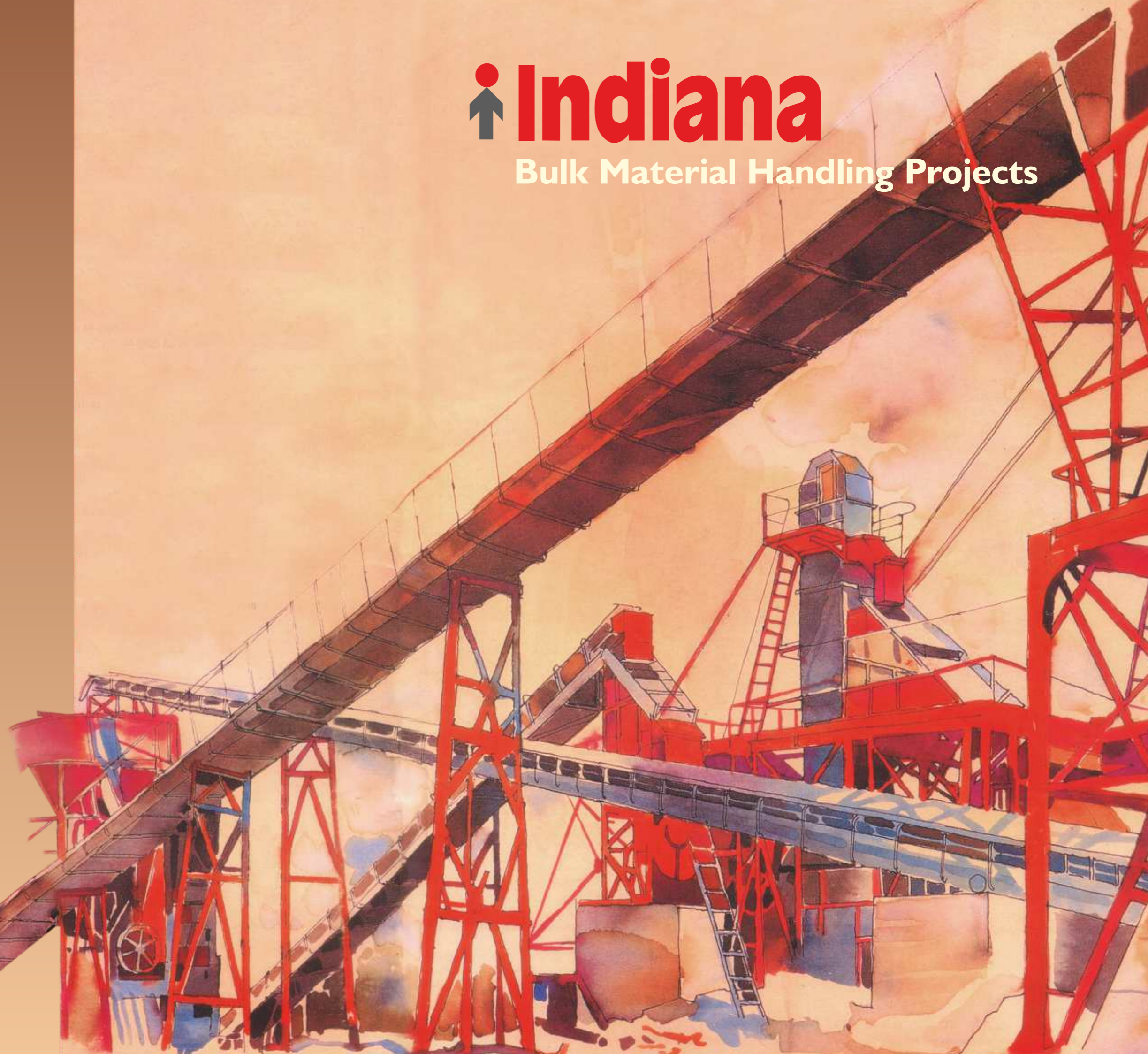



Contents



About Us

The Group
Mission
Head Office and Plants

3



Engineering

7



Manufacturing Facilities

9



Project management

Projects

13



Quality

19



Logistics

21

Material Handling Projects

Steel
Cement
Power
Fertilizer

23



Conveyors

Belt Conveyors
Bucket Elevators
Screw Conveyors
Other Equipment

31



Conveyor Components

Idlers
Pulleys

37

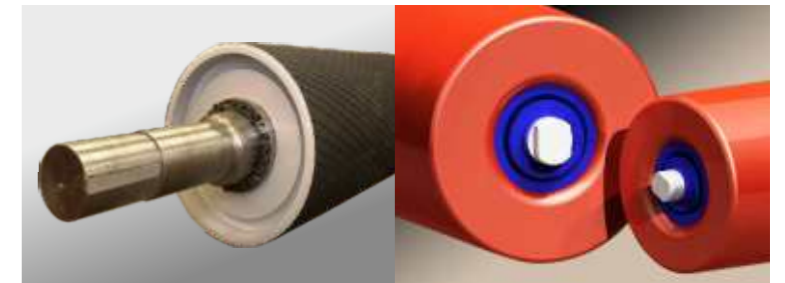

Health & Safety

41



Industries Served

43



Client References

45





About Us

Indiana is a reliable and quality provider of bulk material handling equipment and services catering to the demanding and challenging needs of Indian as well as International customers.

Indiana operates from its head office in Mumbai with a network of branch offices in India.



Head Office at Mumbai

Our Mission

To aim for and maintain Indiana's leading position in the bulk material handling systems field by delivering high quality products and services to our clients.

To achieve this, we engage motivated, highly skilled and trained engineering and technical manpower working in a congenial and professionally conducive business environment resulting in quality and timely output. We provide our employees and business associates all help and opportunities for their professional and personal growth.

We strive to become an integral part of our client's business by building a strong trust-based relationship and work towards exceeding their expectations every time.

All our actions are client-centric, and the goal is customer delight.

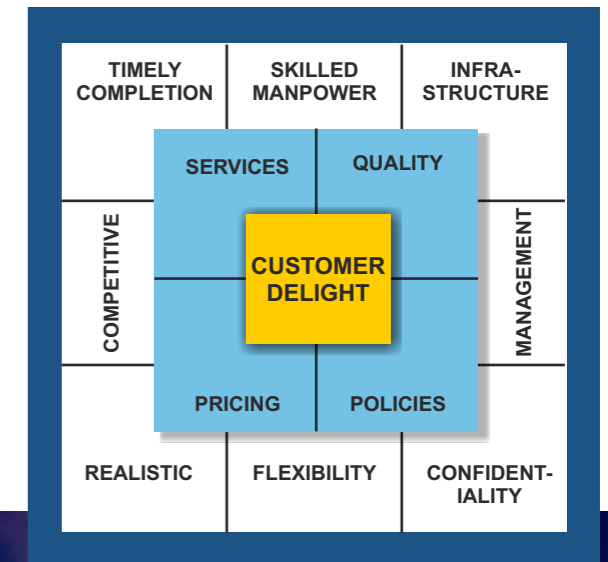

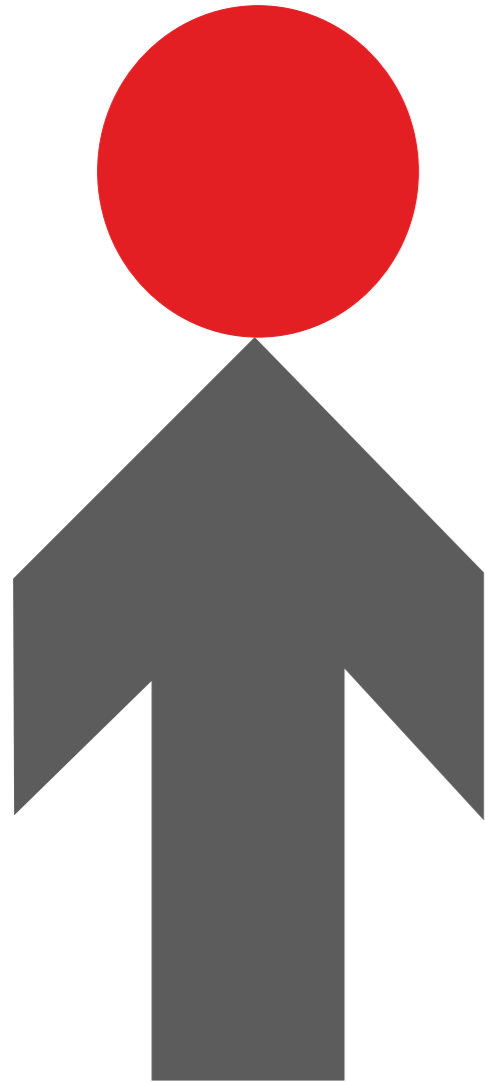

Our Group

Our manufacturing plant in Jejuri (near Pune) is well equipped to undertake equipment manufacturing as well as structural fabrication. The company is part of the Indiana Group, which besides material handling systems, is a leading manufacturer of electroforged gratings, cable trays, handrails and fabricated steel structures with a group turnover in excess of Rs. 400 crores. The group companies' manufacturing plants are all located in Jejuri (near Pune) and together cover an area of over 25 acres.

Indiana Conveyors Private Limited is a leading company in the field of Bulk Material Handling Systems with about four decades of experience in manufacturing related equipment and executing turnkey projects all over India.

The skills and capabilities of Indiana are a result of hard and intelligent work of our engineers and real life learning acquired while working on a wide range of projects in this field. We have carefully studied and analysed the shape, behaviour and dynamics of various materials for projects in material handling projects in steel, fertilizer, cement, coal and power and such diverse industry segments.

Leading company with proven credentials

1. Indiana Engineering Works (Bombay) Pvt. Ltd.
2. Indiana Conveyors Pvt. Ltd.
3. Indiana Gratings Pvt. Ltd.
4. Indiana International
5. Indiana Cable Trays Corporation



Manufacturing plant C-I, Jejuri (Pune)



Manufacturing plant D7, Jejuri (Pune)



Manufacturing plant D9, Jejuri (Pune)

Engineering

Bulk Material Handling Systems need to be custom designed for each application. There is nothing like a "one size fits all" solution. Our engineers utilise years of experience to understand your needs and come up with a customized proposal just right for you.

Our main engineering office is based in Mumbai with another one in Kolkata. These offices are staffed with experienced mechanical, structural, civil and electrical engineers having modern infrastructure in terms of computer hardware and software including custom developed ones.

Our designers understand material characteristics and system engineering. Using this, they can evaluate various options and provide the best layout and equipment specifications. Alternatively, we work to your layouts and detail out the various equipment to your specifications. Either way, you are assured of dealing with engineers with expertise in material handling systems.

Experienced engineers to design the best layout and equipment specifications for your projects.

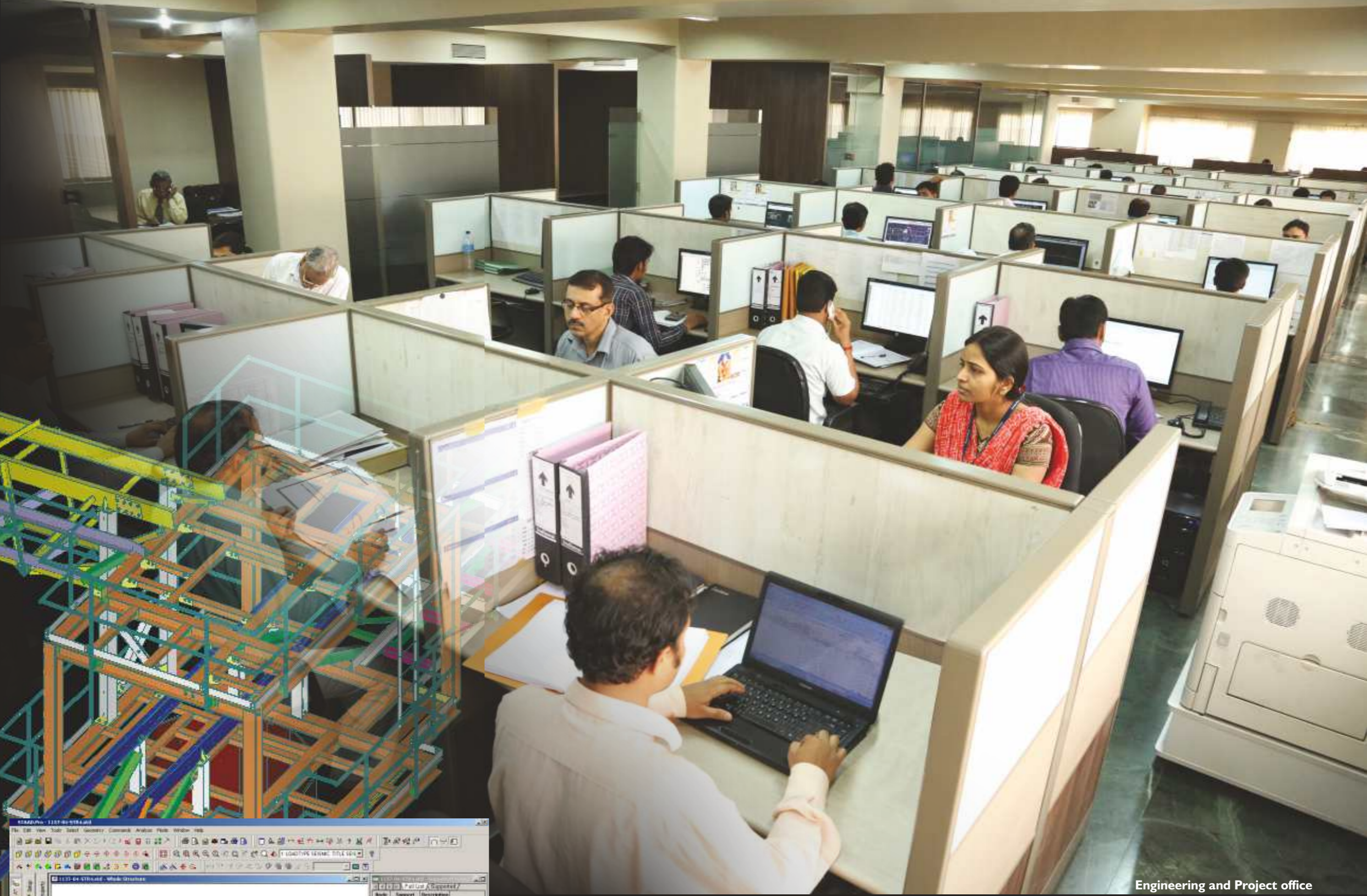

Engineering and Project office

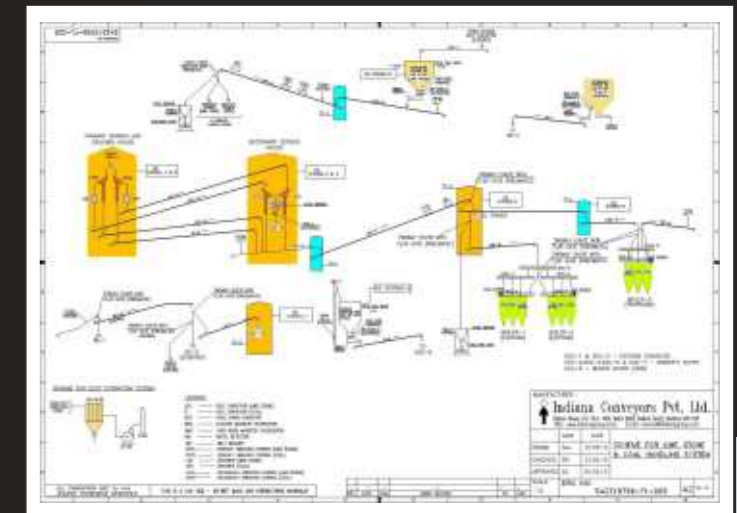
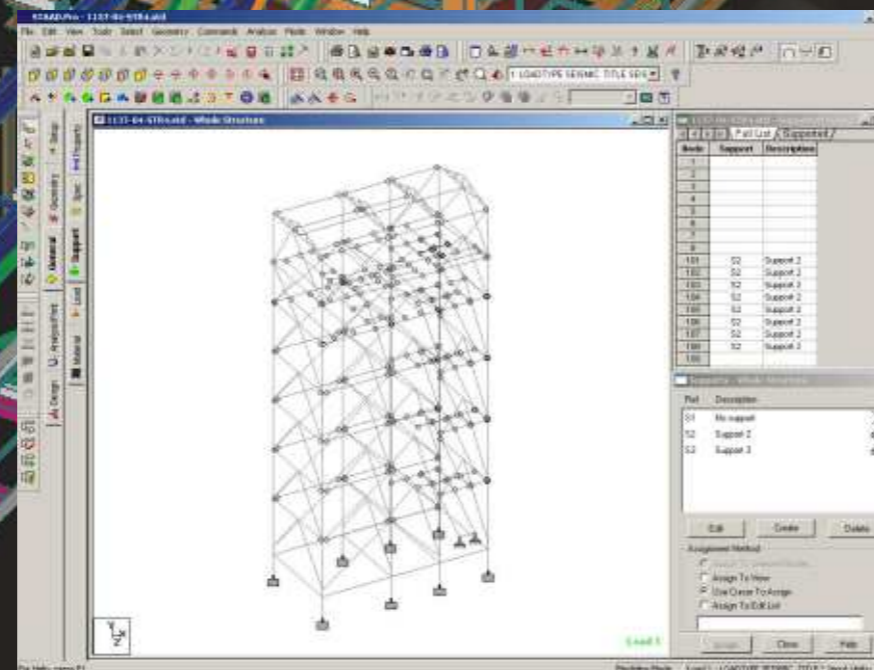



Manufacturing

The overall reliability of our systems is ensured by the fact that critical components like idlers and pulleys are manufactured in-house. Besides, bought-out items are sourced from reliable and approved vendors with whom we have developed close working relationships.

Our manufacturing plants are well laid out with clear material movement pathways. Internal material handling facilities reduce effort and facilitate heavy fabrication to custom designs. Our machine shop is well equipped with indigenous as well as imported machinery. The spacious fabrication bays give us the ability to handle multiple jobs at the same time, while offering enough area for assembly and inspection.

Well laid out plants with excellent manufacturing facilities



One of the bays in our manufacturing plant

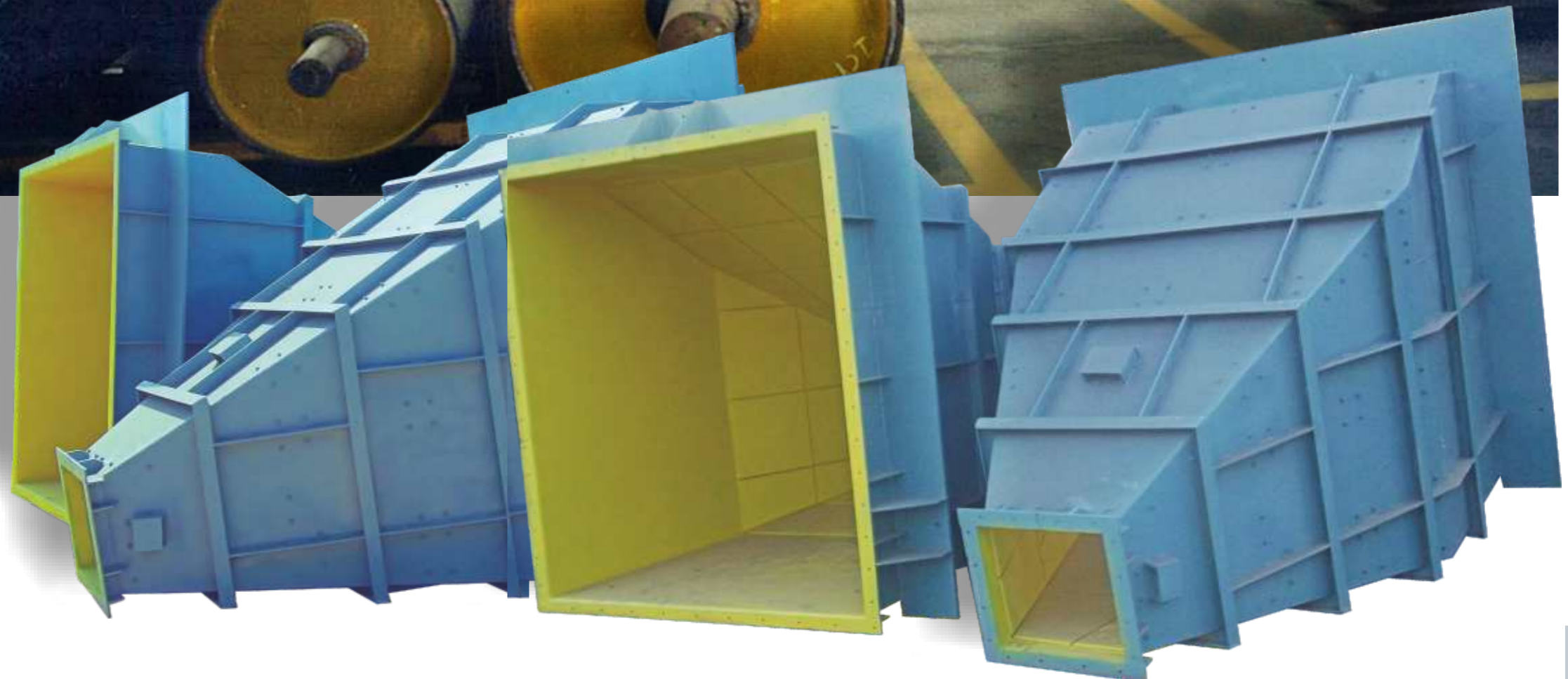



Manufacturing

Our fabrication facilities are equipped with conventional as well as CNC machinery. Skilled workmen with decades of experience give shape to steel with clean cuts and uniform welding. We stock adequate quantities of tested raw materials so your project does not suffer.

Heavy structures are fabricated and assembled here. Large equipment as well as their major components such as bucket elevator casings, hoppers and conveyor galleries are match marked and mock assembly is generally done to ensure proper assembly and installation at customer site. Fabrication bays have large open areas and handling facilities. Surface preparation and painting as required is achieved with due care for the environment.





Project Management



Engineering, Procurement and Manufacturing activities are listed and mapped to the customer's project schedule to bring out a detailed micro schedule that is continuously monitored on software. Similarly, depending on project scope, construction and erection plans are worked out.

Any risk factor that is likely to affect project schedule is analysed and suitable preventive action put in place to overcome such a situation. Project Management procedures are strictly adhered to by every team member, this is ensured by the team leader. All this is possible thanks to superior controls.

Any changes to the scope or schedule, necessitated by customer actions, are carefully incorporated so as to cause minimum disruptions. Time and cost overruns are prevented by timely action and closely supervised at management level. Commissioning is undertaken in consultation with customer or consultants. Total Quality Management is practiced at every stage, while keeping an eye on the deadline.

Well documented procedures, work schedules and monitoring activities are essential to timely completion.

Project management techniques and communication are integral part of training at Indiana.

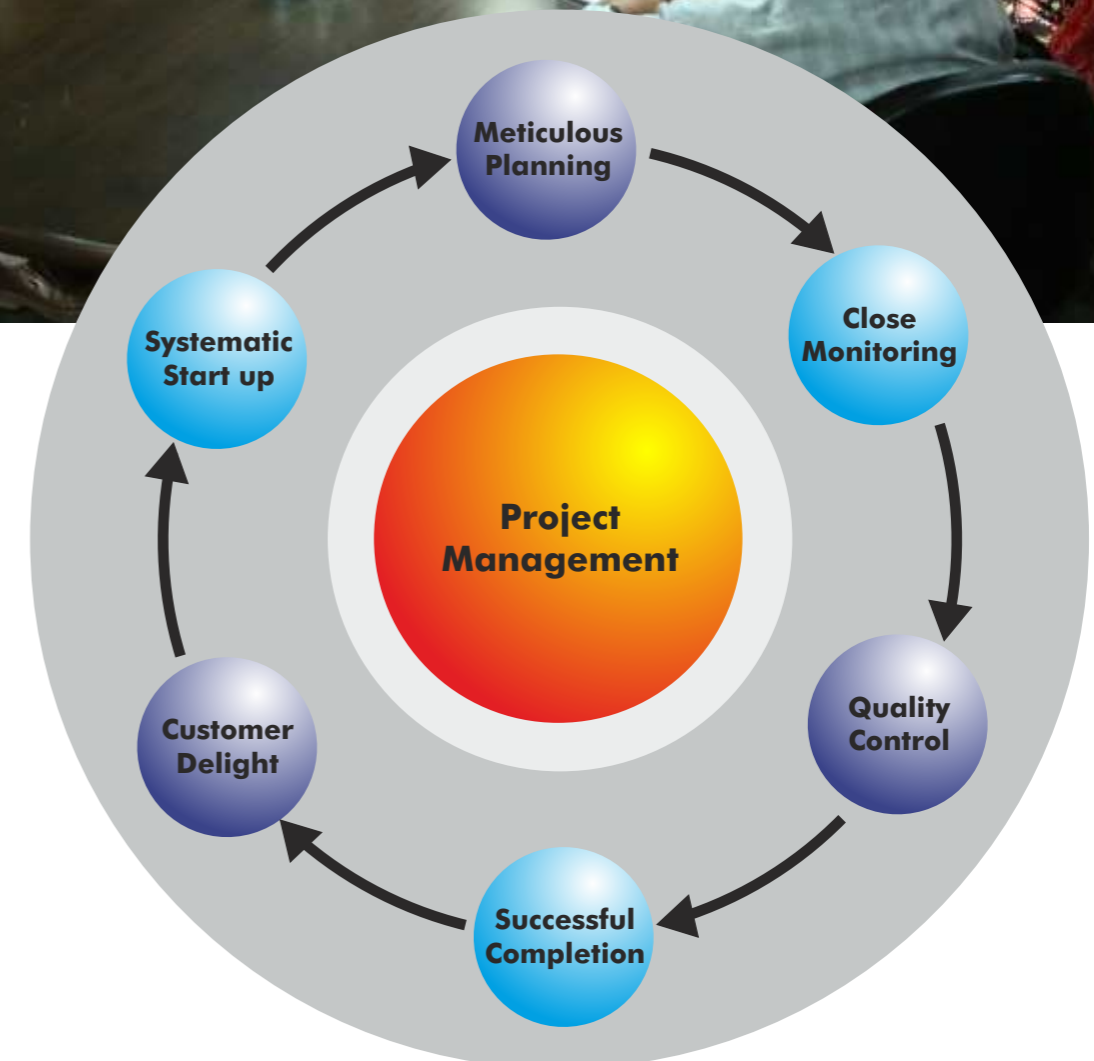
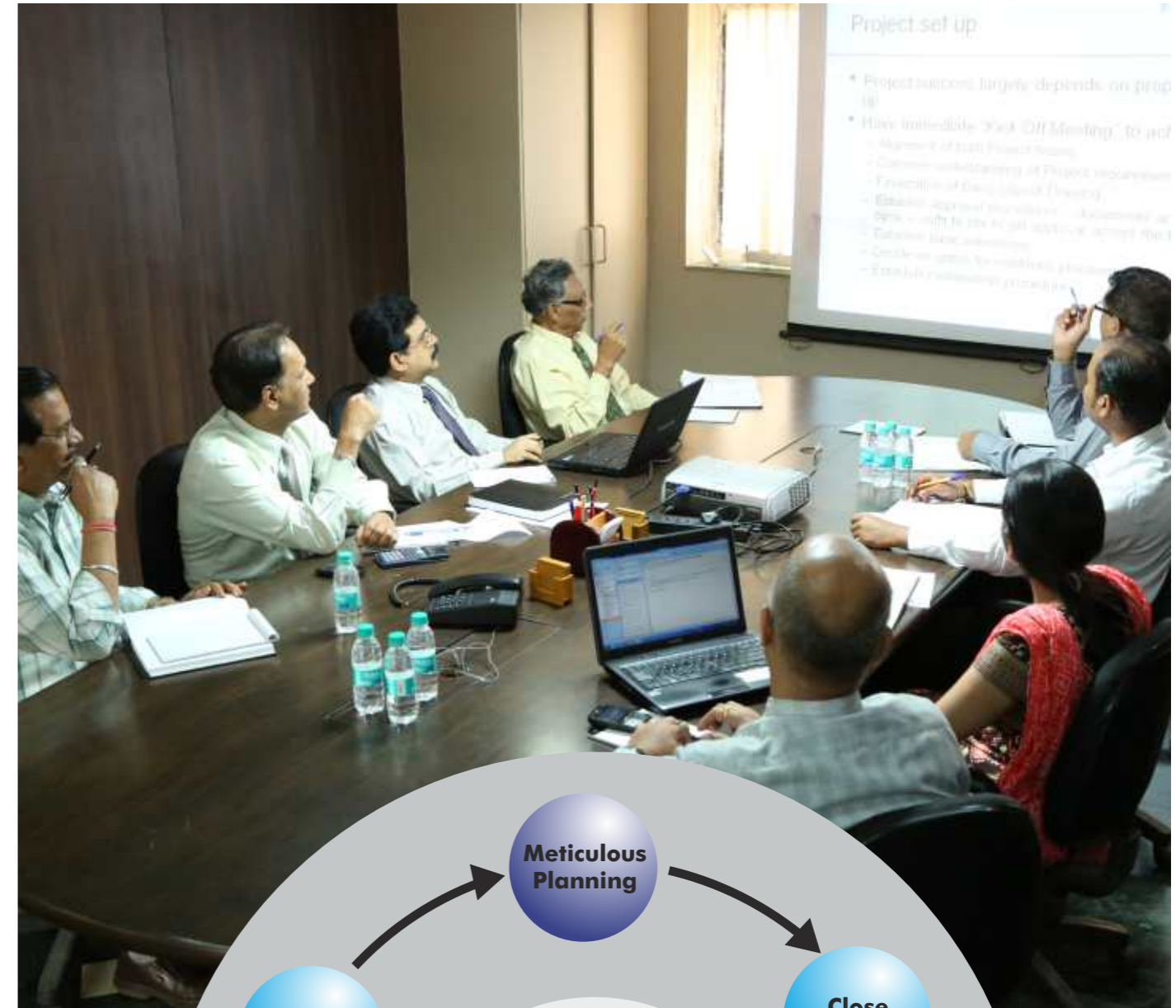



Projects

Indiana manages projects from concept through commissioning. Over the years, we have developed project construction skills to undertake bulk Material Handling projects on turnkey basis for core sectors of the industry.

We have completed several projects for steel, cement, fertilizers, chemicals, coal and power etc.

Project management techniques to meet deadlines



Erection of gantry for 150 TPH gypsum handling plant at Coromandel Fertilizers, Vizag



Installation of conveying system with cyclone at Kribhco Hazira



Alignment of idlers at Coromandel Fertilizers Vizag



Installation of conveyor galleries at Indo Jordan chemicals, Jordan



600 TPH Material handling system in Arab Potash, Jordan



Conveyor system in Balco Korba



Projects

Our team of engineers have hands-on experience in managing projects and work directly with the Engineering, Procurement, Manufacturing and Installation groups to ensure on-time performance. Availability of construction machinery and equipment at short notice with reliable and experienced sub-contractors give us the advantage.

We maintain adequate stocks of materials thanks to our strong financial base and this ensures uninterrupted supply of material for your project.



150 TPH pet Coke handling system in Numaligarh Refinery, Assam



Conveying system in process industry



Gallery erection in progress



Structural installation in Orissa



Tripper for 3500 TPH Belt conveyor system reaching Iffco, Paradeep



Conveyor structures at Indo Jordan Chemicals, Jordan



Coal handling plant control room for 25 MW CPP in Kanoria Chemicals, Renukoot



900 TPH coke handling system in Reliance, Jamnagar

Quality

Quality management is an organisation - wide approach to understanding what a customer needs and consistently delivering precise solutions within budgeted costs and using safe practices leading to:

- Improved customer satisfaction
- Better and innovative working methods
- Increased efficiency and reduction of wastage of materials, manpower and time- hence costs
- Making working environment safe for every one
- Reduction of business risks
- Corporate care and responsibility



Stage inspection of pulley



Idler bearing friction factor testing machine



Roller conveyor inspection



Conveyor alignment and inspection

Quality happens through people

Indiana Conveyors Pvt. Ltd.

QUALITY POLICY

We at Indiana are committed to providing our Clients with quality product and services through a process of continual improvement in all areas of our performance.

QUALITY OBJECTIVES

- To establish and maintain a Quality System in our Organization to facilitate the implementation of our Quality Policy.
- To aim for client delight in all our actions.
- To raise the quality of our product and services to International Standard to facilitate our progress in the global market.
- To consistently develop skills and knowledge of our employees.

Ashok Mask
 Managing Director



Sl. No.	Particulars	Quantity	Unit	Rate	Amount
1
2
3
4
5
6
7
8
9
10

CERTIFICATE 

Management system as per
ISO 9001 : 2008

In accordance with TUV NORD CERT procedures, it is hereby certified that

INDIANA CONVEYORS PRIVATE LIMITED
 HEAD OFFICE : Indiana House, Marol Naka,
 Andheri (East), Mumbai - 400 059
 WORKS : Plot No. C-1, MIDC, Jejuri,
 Tal. Purandar, Dist. Pune - 412 303,
 India

applies a management system in line with the above standard for the following scope

**Design, Development, Manufacturing, Supply and
Project Management of Bulk Material Handling Systems**

Certificate Registration No. 44 58 12480 Valid until 21.08.2016
 Audit Report No. 2.5-0110213

 Certification Body
 at TUV NORD CERT GmbH Issue 22.02.2013
 Pune - Mumbai

This certificate was issued in accordance with the TUV NORD CERT testing and
 certification procedures and is subject to regular surveillance audits.

TUV NORD CERT GmbH Lagerstrasse 20 40474 Essen www.tuvnordcert.com

 IAF

TUV 24-01-05-01





Logistics

There is more to logistics than just the movement of goods from one place to another. Effective logistics involves proper management, planning and accurate forecast of project requirements at installation sites. This requires good engineering and manufacturing schedules and despatch planning. Our plant is well connected to state highway networks facilitating despatch of materials by trucks, trailers and containers. We deliver items accurately, efficiently and in a time bound manner to the project site where it is required.

Some projects involve challenging requirements for oversize despatches. Items like elevator casings are huge volume cargoes and our despatch department has tied up with transporters who provide special low bed trailers to carry these. Routes are optimized to not only reach in the quickest possible time, but also at competitive costs.

Projects are time bound and delays cause not only just loss of revenue but also reputation and customer satisfaction. These are priceless assets, almost impossible to recoup once lost. Indiana recognises this and lays great stress on proper planning and despatches.

Goods reach your project site safely and on time.



High angle conveyor belt despatch

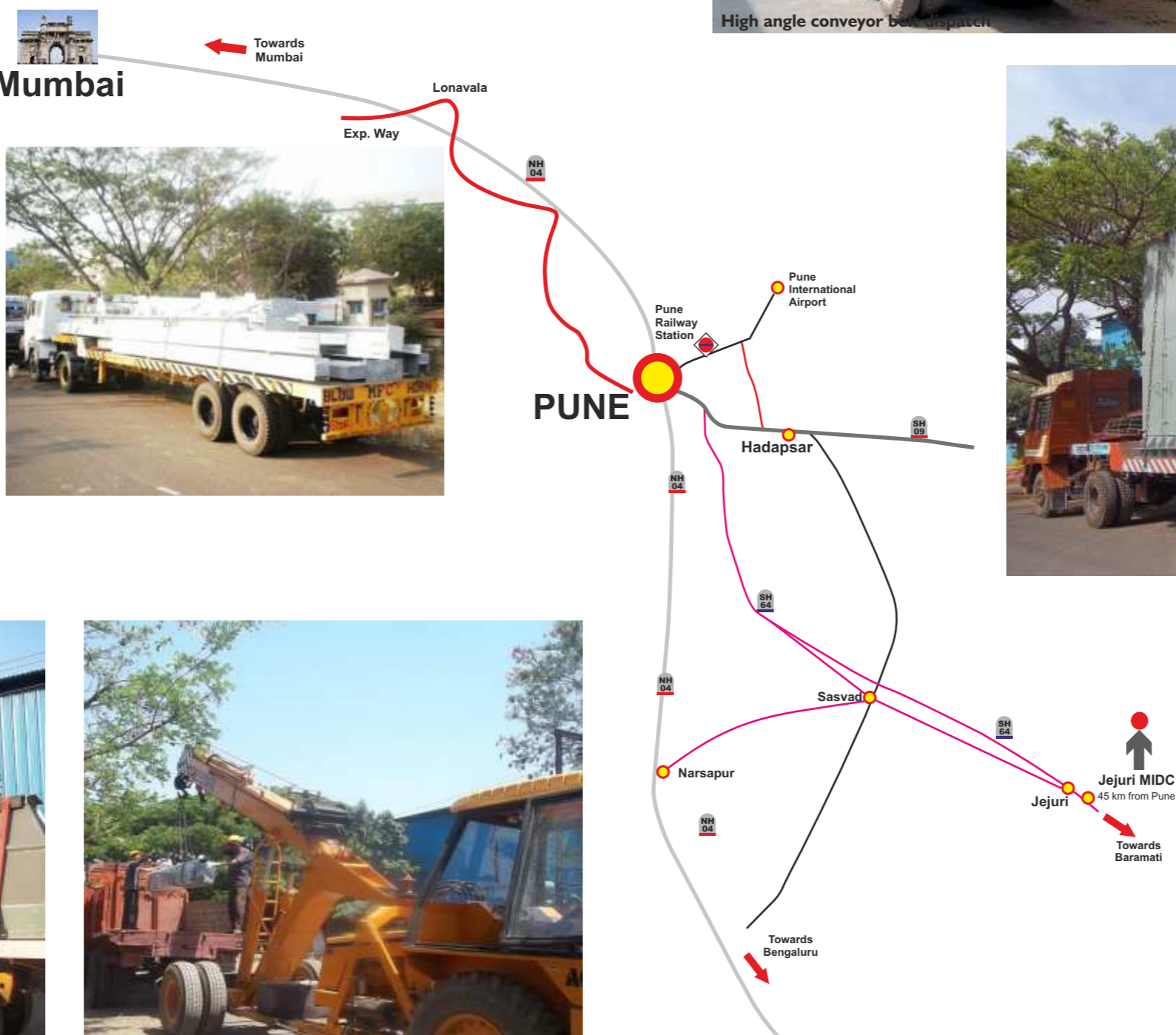



Steel

Our equipment can be found in several steel, sponge iron, pig iron, alloy steel and ferro alloy plants. Indiana has engineered, manufactured and installed various types of conveyors and related equipment and accessories for:

- Raw material handling system
- Product handling system
- Batching and weighing applications
- Ferro alloy addition system
- DRI/HBI feeding system
- Coke storage / conveying system
- Sinter plant conveyors
- Conveying system for pellet plant





Fertilizer

Indiana has emerged as the leading company for design, manufacture, supply and installation of material handling systems in the fertilizer industry. Our systems are operating in most plants and we are well versed with the special requirements and demands of the fertilizer industry when it comes to material handling systems for:

- Raw materials and off-sites handling section
- Product handling, conveying and storage
- Bagging plant and finished bag handling
- Wagon and truck loading





Cement

Over the years, Indiana has built up excellent credentials in this major industry segment. It has designed, manufactured and installed belt conveyors, screw conveyors, bucket elevators, deep bucket conveyors, crushers and screens, feeders and spares. Whether it is modernization, expansion or a new project- Indiana can be your partner for material handling systems.

Our equipment are found in:

- Limestone/additives crushing section
- Raw material conveying, storage, extraction and feeding section
- Raw material grinding and transportation, kiln feed section
- Clinkerisation section
- Coal crushing, grinding and feeding section
- Clinker transportation, storage and gypsum storage section
- Cement transportation, storage and packing section



Conveyor system in Jupiter Cements, Porbandar



Screw conveyor in cement plant in Porbandar



Cement Plant



Inside view of conveyor in cement plant

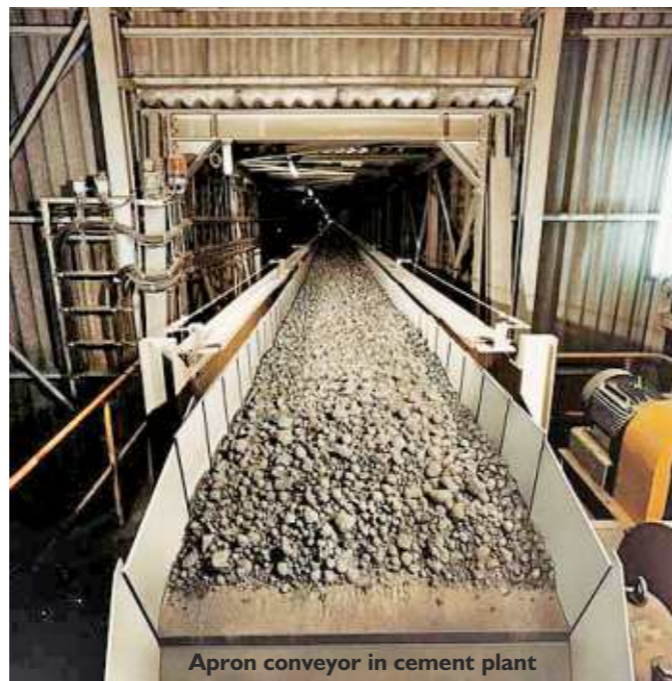

Apron conveyor in cement plant



Conveyor under installation



Deep bucket conveyor for hot clinker in cement plant in Veraval



Power

Coal passes through many different forms till it turns into ash. Indiana has designed, manufactured, supplied and successfully installed systems to handle coal in various forms for boilers.

Indiana can design equipment to meet the operating conditions and physical requirements of important sections of CHP's:

- Raw coal conveying section
- Coal crushing and preparation section
- Crushed coal conveying and storage section
- Ash conveying and storage section



Coal handling plant for 25 MW CPP in Kanoria Chemicals, Renukoot



Coal handling plant for CPP in SAIL, Bokaro



Coal handling plant for 25 MW CPP in Kanoria Chemicals, Renukoot



1200 TPH conveyors for coal handling plant for 3 X 210 MW power plant in Mahagenco, Parli



Pulleys for high capacity conveyors



Conveyors (upto 3300 TPH) in Iffco, Paradeep



Shuttle conveyor in coal handling plant for 3 X 210 MW power plant in Mahagenco, Parli



Belt Conveyors

Advanced design and engineering forms the backbone of our belt conveyors. Indiana has full control over the quality and selection of all components including idlers, rollers, pulleys, brackets etc. as these are designed and manufactured at our own works. Standard belt widths are from 500 mm to 2400 mm.

Indiana has designed, manufactured, installed and commissioned thousands of belt conveyors. Such vast experience has put us in a very favorable situation to make most appropriate techno-economic selection of a belt conveyor for any specific set of conditions for any industry such as steel, cement, coal, fertilizers, metals and mining, chemicals, food grains, infrastructure and port trusts.



Conveyors in Balco Korba



Conveyor gallery in Coromandel Fertilizers, Kakinada



Conveyor in Coromandel Fertilizer, Vizag



Belt conveyor system in Balco Korba



Belt conveyor in Kanoria chemicals Renukoot



High angle conveyor in Kribhco Hazira



Bucket Elevators

Our engineers have, over the last two decades, accumulated experience in elevating a variety of bulk solids and in the process solved many complex problems. Indiana bucket elevators are made to a standard high quality design based on IS: 7167 or IS: 12941 (for super capacity bucket elevators).

Indiana has supplied bucket elevators for capacities upto 1000 TPH and heights about 60 metres for challenging applications such as fertilizer applications.

Six types of elevators are included in Indiana's manufacturing program to cover most of the applications:

- 1. Centrifugal belt type
- 2. Centrifugal chain type
- 3. Centrifugal link chain type
- 4. Continuous belt type
- 5. Continuous chain type
- 6. Positive chain type

World's biggest Bucket Elevators in fertilizer plants

Oswal / Iffco Paradeep	680 / 720 TPH
Coromandel Fertilizers	400 / 450 TPH

Bottom casings for super capacity bucket elevators

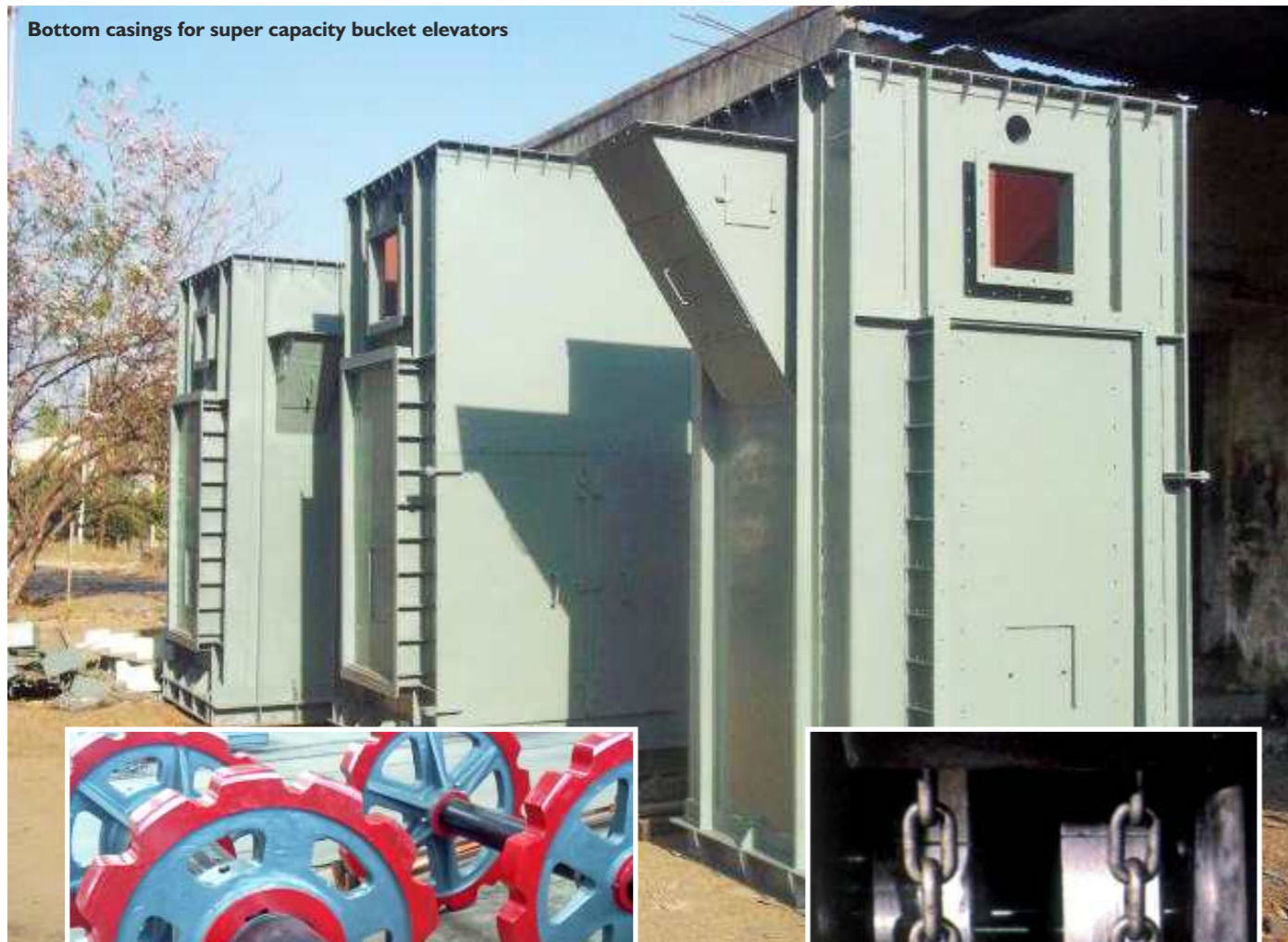

Sprocket assembly



Super capacity (450 TPH) bucket elevators in Coromandel Fertilizers, Kakinada



Screw Conveyors

Indiana manufactures screw conveyor based on IS: 5563 and has manufactured screw conveyors for virtually all applications, materials and capacities. Equipped with custom-built machinery, Indiana offers short delivery schedules at prices which are realistic. All this is possible because of in-house standardization at various stages.

The quality of Indiana screw conveyors is acknowledged as the best with totally reliable performance.

Our range includes screws from 200 mm to 1600 mm dia in MS/SS construction with various flight forms for different applications.



Shop assembly and trial of extra long 750MM dia SS screw conveyor



Other Equipment

Indiana manufactures or sources variety of other equipment as part of a bulk material handling system.



Special belt feeder



Vibrating Screen



SS. bin activators

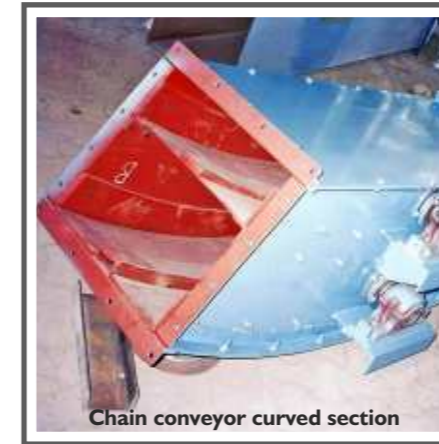

Chain conveyor curved section



Rotary airlock valve



Diverter gates



Conveyor discharge section



Hammer mill

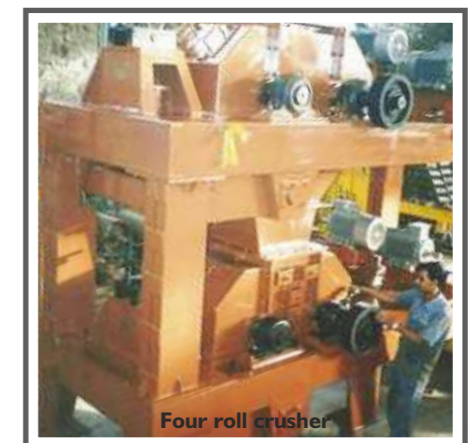

Four roll crusher



Idlers

Engineering skill sharpened over two decades of experience in design manufacturing and installation of conveyor systems have been incorporated in design, engineering and manufacturing of idler rollers. Idlers greatly influence belt tensions, power requirements, belt life, capacity and operational success of a conveyer. Our idlers are rugged and totally reliable. We use quality tubes for shells and standard seize resistant bearings from reputed manufacturers. An elaborate and effective sealing arrangement keeps dust and moisture out. Idler frames are steel fabricated with rigid brackets and generous roll clearances. Inverted angle base gives self-cleaning design, eliminating material build up at the base of the frame.

An array of specially developed testing apparatus for conducting tests such as overall dimensions, radial runout and concentricity, axial shiftability, free rotation, water and dust ingress and friction factor can be utilized to ensure compliance.

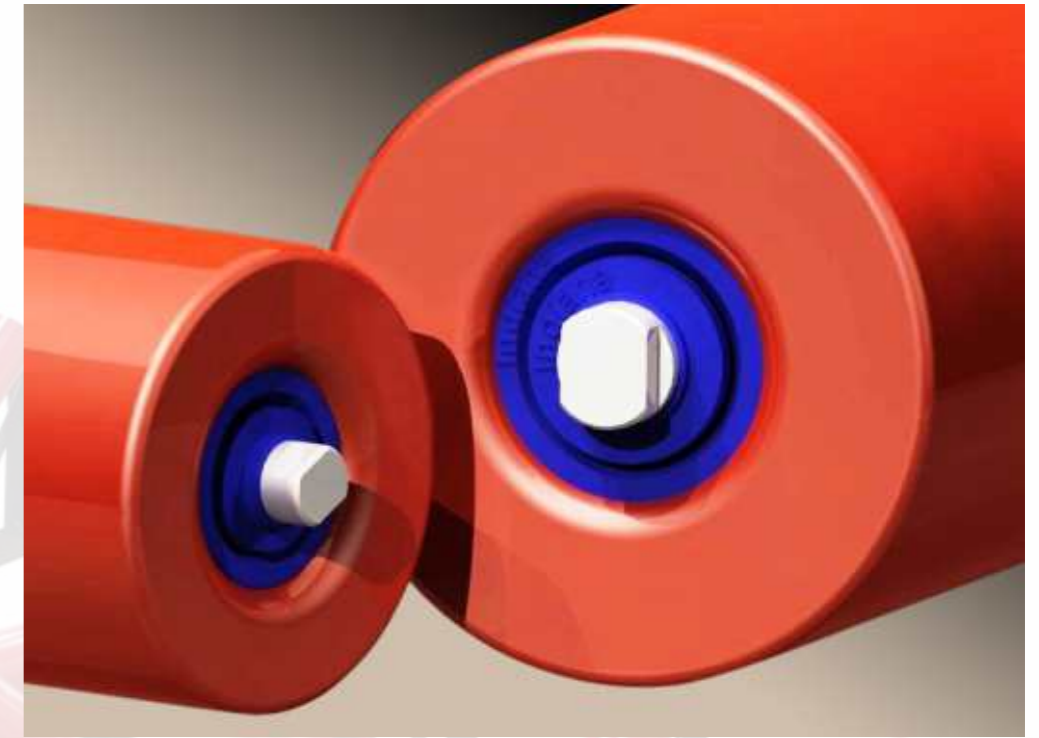

BELT WIDTH	ROLLER LENGTH			MOUNTING DIMENSIONS			HEIGHT DIMENSION 'H' ROLLER DIA. 'D'							
	W	L	L3	L1	L2	M	88.9	101.6	114.3	127	139.7	152.4	159	165
500	200	600	790	855	M12	-	-	225	225	225	-	-	-	-
650	250	750	940	1000	M12	-	-	225	225	275	-	-	-	-
800	315	950	1090	1150	M12	-	-	225	225	275	275	275	-	-
1000	380	1150	1290	1350	M12	-	-	225	225	275	275	275	-	-
1200	465	1400	1490	1560	M16	-	-	240	240	275	275	275	290	-
1400	530	1600	1690	1750	M16	-	-	240	240	275	275	275	290	-
1600	600	1800	1900	1950	M16	-	-	240	240	275	275	275	290	-
1800	670	2000	2100	2150	M20	-	-	240	240	275	275	275	290	-
2000	750	2200	2300	2350	M20	-	-	240	240	275	275	275	290	-

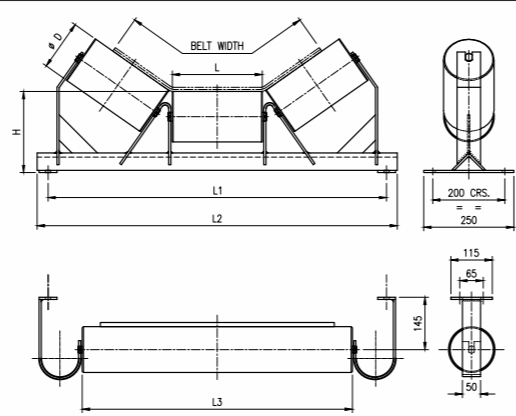

Roller assembly stations



SPM for Roller welding



Idler frames

Pulleys

Indiana pulleys are of heavy duty construction, suitable for continuous operation. Pulley assembly dimensions and tolerances are based on IS or IPSS specifications. Pulley shells are either made from standard heavy tubes or fabricated from steel plates. Depending upon the face width, two or three diaphragms are provided. Pulley shafts are of carbon steel and fully machined to precise tolerances.

Assembly of pulley and shaft is usually accomplished through a bore and keyway. However, taper lock bushings are also offered. Heavy duty split-type plummer blocks, equipped with self-aligning double row ball/roller/taper roller bearings, with adequate dust sealing shaft runs between standard take-up blocks with antifriction self-aligning ball bearings, sliding between parallel guides, provided in the structure.

Straight or crowned faces are available in all combinations of diameters and face width. They may be furnished with rubber lagging usually grooved to resist slippage. Static balancing of pulleys ensures increased bearing life and reduced power consumption.

∅d	∅d1	L1	L2	L3	J	H	G	E	X
∅50	∅45	135	80	55	210	70	M16	102	—
∅65	∅60	170	105	65	230	80	M16	150	—
∅80	∅75	185	105	80	290	100	M20	165	—
∅100	∅95	225	130	95	350	125	M24	260	—
∅125	∅120	275	165	110	420	150	M30	—	—
∅140	∅130	335	200	135	480	170	M30	—	130
∅160	∅150	350	200	150	540	190	M30	—	150
∅180	∅170	400	240	160	610	210	M33	—	170
∅200	∅190	455	280	175	680	240	M36	—	190
∅220	∅210	460	280	180	740	260	M39	—	200
∅240	∅230	475	280	195	790	280	M39	—	210

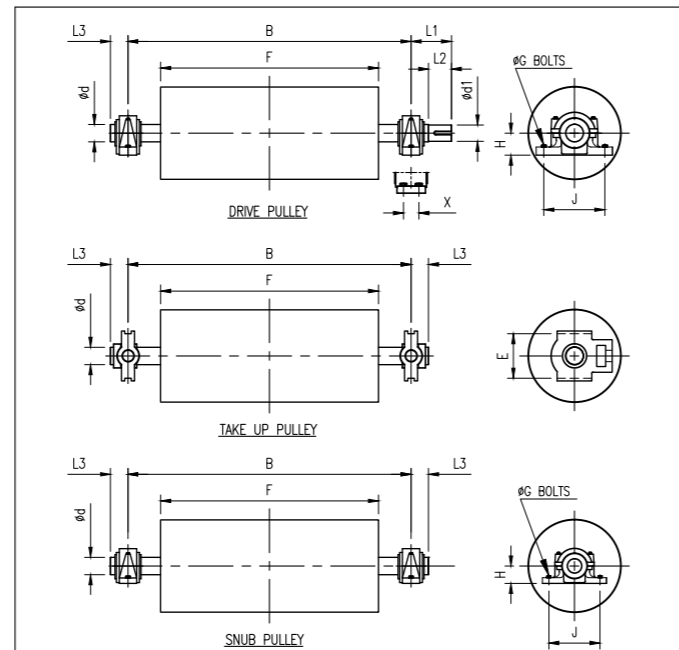

B.W.	500	650	800	1000	1200	1400	1600	1800	2000
F	600	750	950	1150	1400	1600	1800	2000	2200
B	950	1100	1300	1500	1850	2050	2250	2450	2650

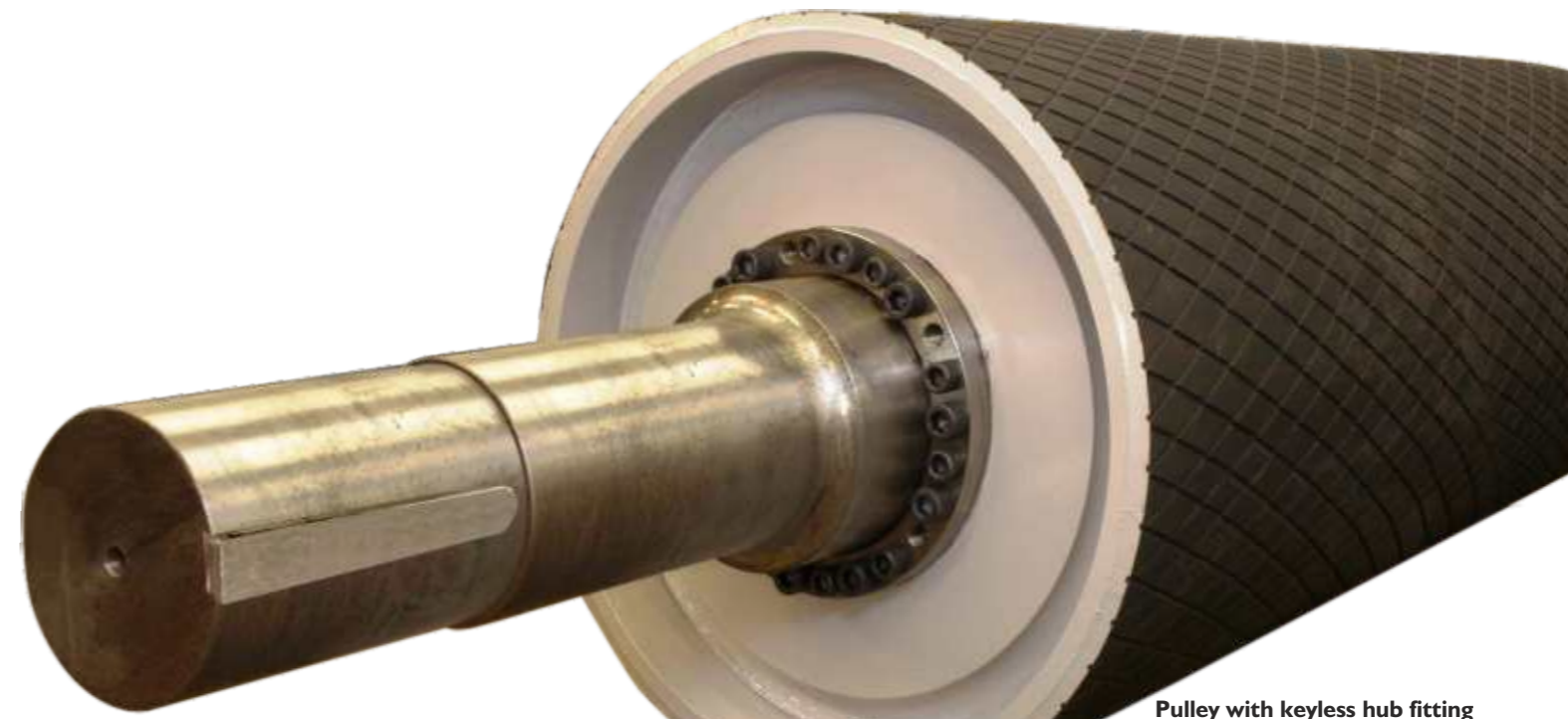

Pulley with keyless hub fitting



Material handling system in Iffco Paradeep



Pulley shell-diaphragm welding



Large pulley machining



Pulleys ready for packing and dispatch

Health & Safety



Indiana Conveyors conduct its entire operations in accordance with the highest standards for safety, ensuring safe working conditions through right work process. It makes strict compliance of all safety rules, local or national and regulations mandatory.

Safety, Health and Welfare of all its personnel and smooth and perfect operation of all its equipment at works.

Safety is not just a buzzword but a way of life at Indiana. All our plants implement safety measures at every level and all over the plant areas.

Safety Efforts include:

- Providing guards in machines
- Enclosing and guarding potentially dangerous machines
- Neutralising energy sources during maintenance and repairs
- Providing personal protective equipment
- Prohibiting work on live equipment or installations without proper safeguards in place
- Providing safety switches
- Prohibiting use of double adaptors and piggyback plugs
- Using insulating gloves

Training helps to ensure that workers have the appropriate skills and knowledge to perform their work safely and boost their morale. We discourage staff and workmen from working without protective gear and supervisors are instructed to enforce all safety measures across all areas.

Working areas are properly illuminated and extra lighting provided for any precision machine and inspection tasks. Shop floors are hard floored with clear markings. All tools and hand machinery are placed in allotted spaces after usage.

All safety practices are reviewed on a regular basis and updated based on employee feedback and newer methods available.

Training

We recognize the need for well trained people for successful implementation of the projects to delight our customers.

We also recognize that for continual improvement of our services development of our people is essential.

For developing management skills of our engineers, we have developed in-house training programmes on Project Management techniques, team building, communication and other soft skills.



Safety is success by purpose, not accident





Industries Served

Power

- Coal & limestone conveying system from jetty to storage yards.
- Coal handling system for unloading, stacking, crushing, screening, conveying to boiler bunkers.
- Mechanical ash handling system
- Limestone crushing, conveying and feeding to boiler bunkers.
- Coal feeders to boilers.



Oil Refineries

- Coke and petcoke unloading from coke oven batteries, crushing and conveying system through conveyors to storage silos / plant.
- Bitumen drum handling system.



Steel

- Raw materials - iron ore, limestone, coke, dolomite, etc. Conveying, storage & reclaiming.
- Crushing, screening and conveying to storage bunkers.
- Weighing, batching and conveying system.
- Product handling & conveying system to steel melting furnace
- Ferro alloy unloading, batching, conveying, addition system to arc furnace / ladle furnace.
- DRI / HBI conveying, storage, batching and feeding system.



Cement

- Raw materials limestone, coal, dolomite, etc. Unloading, storage, conveying system handling system.
- Coal & limestone crushing, screening and conveying system
- Product handling, weighing and conveying to cement mill.
- Bagging and packing plant conveying system & stacking of bagged material.
- Clinker grinding & conveying system.



Metal and Mining

- Raw materials handling - iron ore, bauxite, coal minerals, etc., reclaiming and conveying to stockpiles.
- Raw materials crushing & screening system.
- Product handling & conveying system.



Fertilizer

- Off sites unloading, storage, conveying system.
- Limestone crushing, screening & conveying system.
- Inplant & process plant handling, elevating and conveying system to process equipments.
- Conveying from plant to bagging plant, raw material storage, weighing, bagging, stitching, bag conveying and distribution to wagon / loading / bagged storage platforms.



Chemicals

- Salt handling system for caustic soda plant conveying to storage yard.
- Reclaiming & conveying of salt to brine tanks.
- Sulphur handling system involving belt conveyors, trippers for storage, weighing & conveying to sulphur melters.
- Carbon black handling.



Sugar

- Bagasse handling and conveying system.
- Bag conveying system.



Infrastructure

- Raw materials - aggregates crushing, screening and conveying systems.
- Batching and conveying system for aggregates.



Ports

- Raw materials like coal, fertilizer products, grains, etc unloading from jetty / ships and conveying system.
- Raw materials conveying through trippers / shuttle conveyors to stockpiles.



Pulp and Paper mills

- Bagasse handling, crushing and conveying system for co-gen plant.
- Rice husk / wood chips crushing, handling and conveying system for co-gen plant.
- Bale handling & conveying system.



Other Industries

- Belt conveyors, elevators & screw conveyors, weigh feeders, vibro feeders, rotary feeders, roller conveyors, gates etc. For handling raw materials in glass, granite, ceramics, polyester yarn and films, textiles and ceramics plant.
- Coal and ash handling systems for captive power plants.

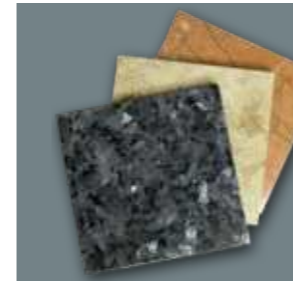



References

Our credential list includes top names in the Indian industry. We have worked for end users and project contractors, EPC companies and consultants covering wide range of industries. Indiana is on the approved list of major consultants in the field.



**“In case of doubt,
decide in favour
of what is right.”**

- Karl Kraus, Austrian Writer

